

Yoswit Smart Switch Module Datasheet

Model: YO619 (R2)

Revised: 01-12-2024



Transform Your Lighting Experience

Yoswit Smart Switch Module features a mini design that hides in the wire box, effortlessly replacing your original wall switches while allowing you to control your lights through the Yoswit app. Experience wireless control without the need for a hub, and our proprietary topology extends the control distance of the Yoswit device network. Automate lighting with the built-in timer. Once connected to a hub, you can remotely control the switch and integrate it with your smart speakers. Create a symphony of smart living with intelligent linkage among all Yoswit products.

Connection :

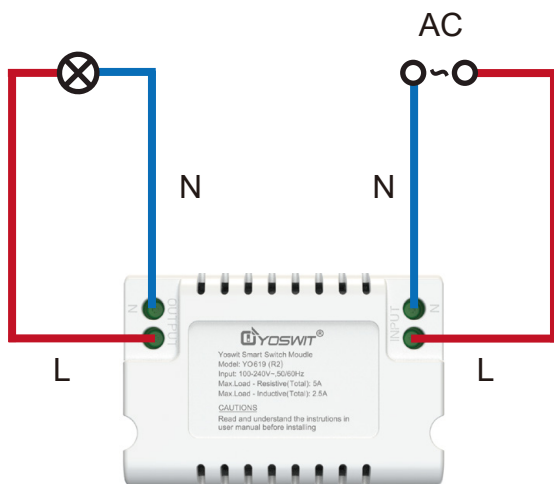

Key Features and Benefits

- No Switch Box Dependency
- Built-in Timer for Automation
- Proprietary Topology for Mesh-like Network
- No Hub Required for Wireless Control
- Connects to a Hub for Remote Control
- Smart Speaker Integration

Various Customized Products

We offer a comprehensive selection of smart home products that are seamlessly adapted to the usage standards and various socket types in different countries, ensuring a smooth installation process for all users. With extensive compatibility, our products enable you to control a diverse range of household appliances, including lighting, air conditioning, and TV.



Light Switch



Dimmer Switch



2 Way Switch



Double Pole Switch



Gate Controlled Switch



Hidden Controlled Switch



Outlet



Roller



Curtain



Remote Control



Thermostat

Yoswit App

You can download our app to implement the following functions via Bluetooth and WiFi to control the Yoswit switches.

Time Setting

Scene Mode

Device Network

Away Detection

Password Protection

Network Control

Apple Siri

Google Assistant



IFTTT

Depends on Yoswit Bridge Solutions.

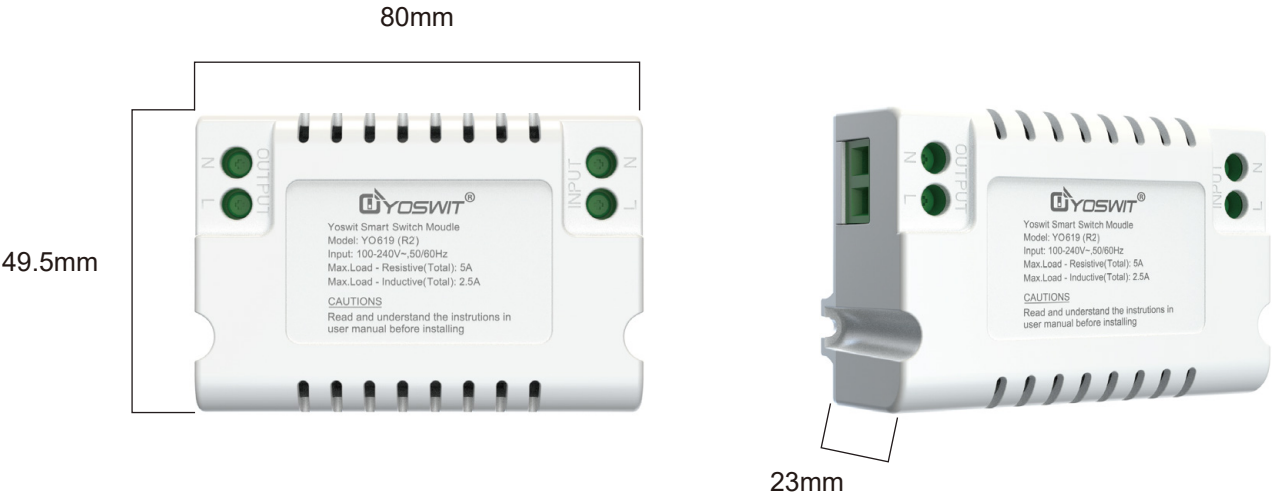

Product Specifications

Specifications:



Electrical	
Input Voltage	100-240V AC (50/60Hz)
Frequency	60/50Hz Auto Detected at Power-up
Resistive Load Current	Max. 10A
Inductive Load Current	Max. 5A
Standby Power	<0.1W

Wireless	
Frequency	2.4GHz
Connection	BLE 4.2
Range	Open Area: >50m / Interior: 3-20m

General Specifications

Product Name	Yoswit Smart Switch Module
Model	YO619 (R2)
EAN / UPC	EAN: 0765756498197 / UPC: 765756498197
Revision	V1.0
Compliance	CE, FCC, RoHS
Manufacturer	Designed by Yoswit in Hong Kong, China / Assembled in Guangdong, China
Warranty	Two Year Limited Warranty (*Details available on the Product Warranty and Limitations of this datasheet)

Mechanical

Storage Conditions	-20°C to 60°C
Operation	APP
Operating Temperature	-10°C to 50°C
Operating Humidity	0-90% RH, Non-Condensing

Product Package

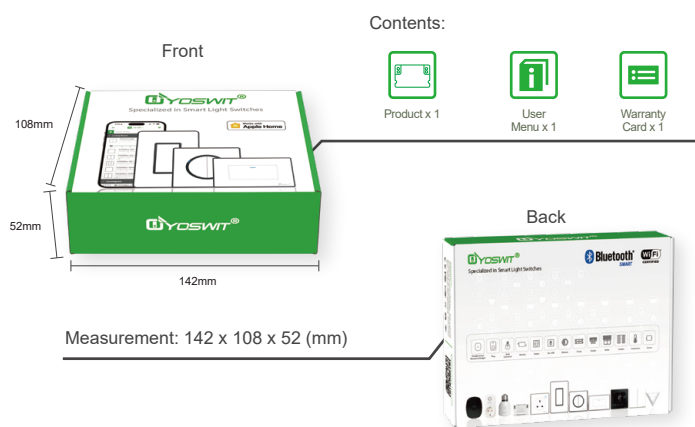

Outer Box



Product Warranty and Limitations

Yoswit brand products guarantee for a period of 2 years warranty from the date of purchase. During the warranty period and in the event that a defective product is identified (non-human factors), Yoswit will provide free maintenance. Damage beyond the warranty period or caused by improper use is not covered within the warranty, Yoswit will not bear any responsibility for repair, and will still provide users with a lifelong maintenance of paid services. If the products need to be repaired or returned to our company, an appropriate fee should be charged based on specific situation to cover the cost of replacement. Regardless of the warranty status, all shipping costs are borne by users.

LINCOGN TECHNOLOGY CO. LIMITED

Address: Room 202, 2/F, Building No. 19 West Science and Technology Avenue, Science Park, Shatin, N.T., Hong Kong
info@yoswit.com | Tel: (852) 3996 9396 | Fax: (852) 3119 8778 | www.yoswit.com